

LiftMaster MyQ Wall Control & Internet Gateway

INSTALLATION GUIDE

Required Items for Installations

Garage Door Compatibility

Opener	Quick ID
LiftMaster compatible brands made after 1998	LiftMaster, Chamberlain, Sears/Craftsman, Raynor and Access opener.
	ALL with a purple learn button with purple antenna wire.
	MOST with an orange/red learn button with gray antenna wire. The following models are incompatible : <ul style="list-style-type: none"> - Models 2500 & 2500C (2500B and 2500BC are compatible) - 1000SDR - 2000SDR
	*See full list of compatible garage door openers at the end of this guide.

Install MyQ Control Panel (888LM)

MyQ Control Panel (888LM)

- 1) Disconnect all electrical power to the garage door opener.
- 2) Remove the existing door control from the wall. Note the polarity of the wires connected to the existing door control. Label the wires appropriately (Red/White).
- 3) Disconnect the wires from the existing door control.
- 4) Connect the wires to the new MyQ Control Panel.
- 5) Mount the MyQ Control Panel to the wall.
- 6) Reconnect power. The yellow command LED (in the center of the MyQ Control Panel) and the red learn LED (above the learn button) will blink quickly for up to 5 minutes as the MyQ Control Panel recharges. When the MyQ Control Panel is operational, the yellow command LED will glow steadily.
- 7) Test the MyQ Control Panel. Press the push bar to activate the garage door opener.
- 8) Connect to LiftMaster Internet Gateway (See instructions below).

1) MyQ Control Panel (888LM)



2) MyQ Internet Gateway (828LM)



3) Compatible Door Opener

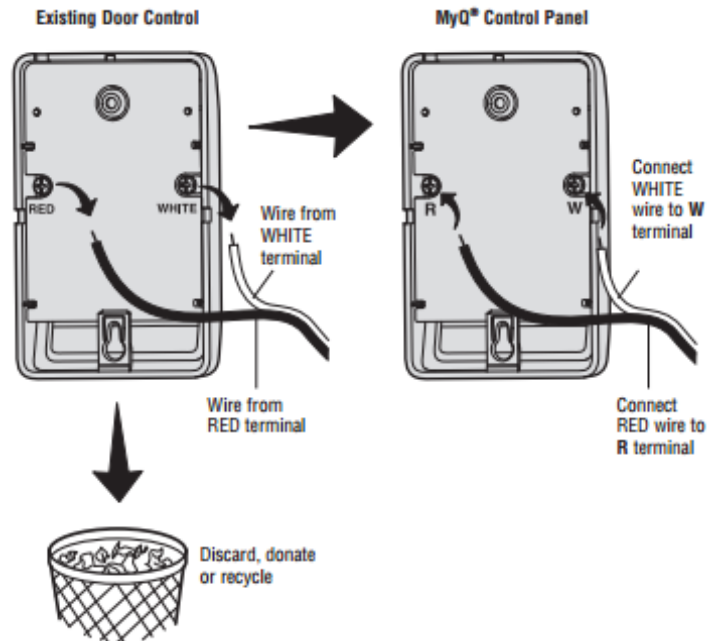

Connect LiftMaster Internet Gateway

- 1) Connect ethernet cable to router and the internet gateway.
- 2) Connect power to the internet gateway.
- 3) When the internet gateway connects to the internet, the green light will stop blinking and will light solid. If the green light does not light solid, check the power, router, and internet connections to the internet gateway.
- 4) Write down the serial number on the gateway to be used in the registration process

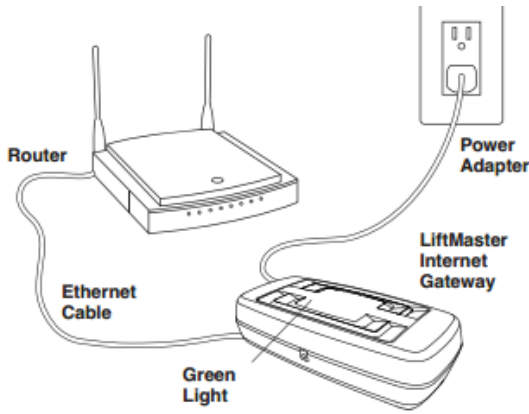

Internet Gateway LED patterns' meanings.

LED Color	LED Pattern	Description
Green	Blinking	The Gateway has an IP address from the router, but is not connected to the internet.
Green	Solid (blinking infrequently)	The Gateway has an active internet connection. Infrequent blinking indicates data traffic.
Blue	Solid	The Gateway has learned at least one MyQ device. The blue light will infrequently blink to indicate communication in progress with MyQ device.
Yellow	Solid	The Gateway is actively waiting to learn a MyQ device. This will timeout after three minutes if a device is not learned.

Register Internet Gateway

Please note: You cannot register the Internet Gateway through Alarm.com if it is already registered through MyQ/LiftMaster. You must delete the Internet Gateway from your MyQ account before attempting to register it to Alarm.com.

There are two different ways to register the Internet Gateway. It can be registered through the Alarm.com Dealer Portal or through the Alarm.com Customer Site. These two options are outlined below.

Option 1: Register the Gateway from the Alarm.com Dealer Portal

- 1) Login to www.alarm.com/dealer
- 2) Find and select the customer to link the gateway to their Alarm.com account.
- 3) Add the "LiftMaster Garage Door Control" add-on to the account's service plan. (Service Plan -> Change Service Plan)

- 4) Go to the emPower equipment page (Equipment -> emPower Devices) and select the LiftMaster device section.

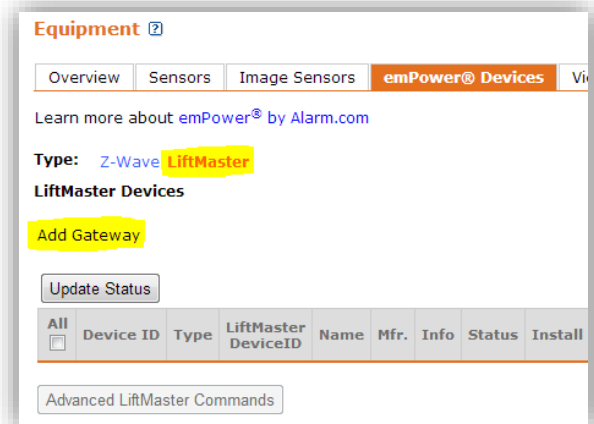

- 5) Select "Add Gateway" and enter the internet gateway's serial number.

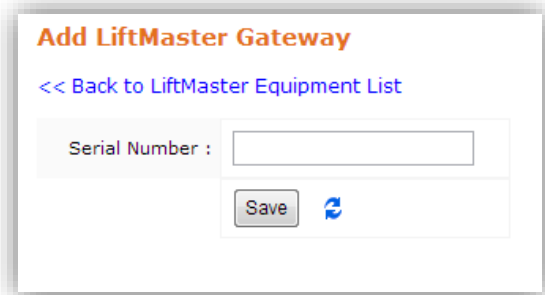

- 6) After a few minutes, the equipment page should show the internet gateway in the equipment list.
- 7) View the LiftMaster Equipment page (Equipment -> emPower Devices -> LiftMaster) and select the "Learn Mode" link for the gateway. This will put the internet gateway into learn mode so that MyQ Control Panel can be added. A yellow light should turn on at the gateway.

All	Device ID	Type	LiftMaster DeviceID	Name	Mfr.	Info	Status	Install Date (EDT)	Maintain Date (EDT)	Status Date (EDT)	Device Commands
<input type="checkbox"/>	2203	Gateway	162468	LiftMaster MyQ Gateway (918D)	LiftMaster	Unknown	OK	3/27/2013 2:17 pm	3/28/2013 7:59 pm	3/27/2013 2:17 pm	Learn Mode

If the yellow light does not turn on, select the "Get Equipment List" button, wait 1 minute and try "Learn Mode" again.

- 8) After the yellow light is on at the internet gateway, go to the MyQ Control Panel (888LM) and push the learn button **twice**. The LED on the gateway will turn blue once the device

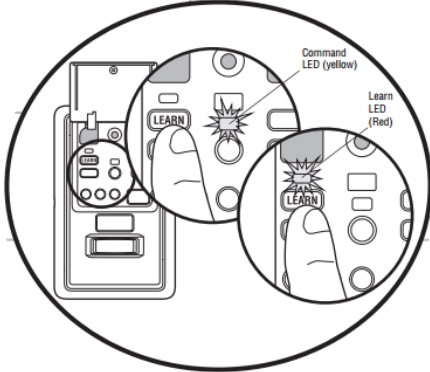

is learned in.

- 9) Select "Get Equipment List". This will retrieve the MyQ Control Panel and link it to the Alarm.com system.

Option 2: Register the Gateway from the Alarm.com Customer Site

- 1) Make sure that the LiftMaster add-on has been added to the customer's service plan.
- 2) Log into www.alarm.com by using customer credentials.
- 3) Access garage door registration through emPower -> Garage.
- 4) Follow the instructions to add a gateway.

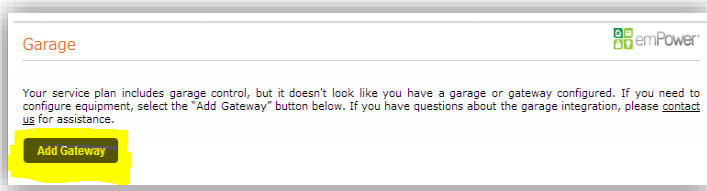

- 5) Enter the serial number of the Gateway and continue
- 6) Select Add New Device to put the Gateway into learn mode.
- 7) After the yellow light is on at the internet gateway, go to the MyQ Control Panel (888LM) and push the learn button **twice**. The LED on the gateway will turn blue once the device is learned in.

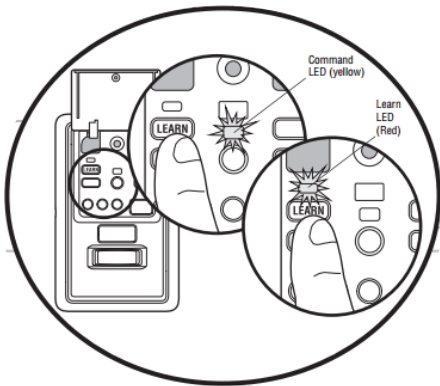

- 8) Return to the Garage page and click "Check for New Devices".
- 9) Repeat steps 6-8 if initially unsuccessful. Also check the model number of your garage door against the complete list of compatible garage door openers below and make sure the

garage door is compatible.

Troubleshooting

- 1) If the yellow command LED does not turn on, reverse the wires connected to the R and W terminals of the control panel. Replace the wire if necessary.
- 2) If yellow and red LEDs are blinking slowly, the control panel is not compatible with your garage door opener.
- 3) If the yellow and red LEDs are blinking quickly, the control panel is charging, and may take up to 5 minutes to become operational.
- 4) MyQ gateway "Learn Mode" is active for 3 minutes during which time devices associated with that gateway will be inoperable.

Factory reset the Internet Gateway:

If you must force a full factory reset (a non-recoverable data destruction "hard" reset) to the internet gateway, disconnect power to the internet gateway and while powered off, use a thin tool, such as paper clip or a toothpick, to press and hold pressed the internet gateway's reset button. While continuing to hold the reset button pressed, connect power to the internet gateway. Continue to hold the reset button pressed for 10 – 20 seconds until the gateway's Yellow light blinks, then immediately release the reset button.

Complete list of compatible garage door openers

Drive	1997-2004	1997-2004	2005-2006	2007-present
Chain	1240R	985		
Chain	1245R		1345	
Chain/DS	1246R (DS)		1346 (DS)	
Chain	1255R		1355	
Chain/DS	1256R (DS)		1356 (DS)	
Chain		2245	3245	
Chain	1265	2255	3255	
Chain		2265	3265	
Chain		2565		
Chain	ATS211R	ATS211X	ATS2113X	
Chain		2575	3575	
Chain/DS		2595 (DS)	3595 (DS)	3895T
Belt		2280	3280	
Belt		2585	3585	3885T
24VDC Belt	2500(B)	2500D	3500	
12VDC Unit			3850	3850T
RJO - 24VDC			3800	3800T
Screw	1000SDR	2110	3110	3240
Screw	2000SDR	2220	3220	3130

Drive	1997-2004	2004	2004	2007-present
Chn/Cble	1200			
Chn/Cble	CG40	CG40S	CG40D	HD200D
Chn/Cble	2200	CG42CS	CG42D	HD200DM
Chn/Cble	PD100	7520S	7520D	HD400D
Chn/Cble	PD200 / PD210	PD210CS		HD400DM
Chn/Cble	PD600 / PD212	PD212C		248730
Chn/Cble	4200		PD210D	248735
Chn/Cble	6200		PD212D	
Chn/Cble	PD610	PD610S	PD610D	
Chn/Cble	PD612K	PD612S		
Chn/Cble	7220 / 7320		PD612D	
Chn/Cble	7420	PD752S	PD752D	
Chn/Cble		PD758S	PD758D	
Belt	8200		WD822D	HD600D
Belt	9200 / 9500		WD922D	248739
Belt	WD822K	WD822S	WD832D	
Belt	WD922K	WD922S		
Belt	WD912K	WD912KS		
24VDC Belt		WD952S	WD952D	248754
12VDC Unit			WD962D	HD900D
Screw	4620 / 4650DI	PD420	PD420/422D	995XDM
Screw	4640 / PD460	7902	PD462D	9950D
Screw	9902 / PD420	9950/9960	9950D	

	1997 - 2005	1997 - 2005	2005+
Chain Drive	Sec+ - 390M hz		Sec+ - 315M hz
Units	139.18050.	139.18657	
	139.18051	139.18658	
	139.18052	139.18659	
	139.18053	139.18660.	
	139.18057	139.18675	
	139.18058	139.18676	
	139.18059	139.18678	
	139.18060.	139.18686	
	139.18063	139.18696	
	139.18070.	139.18847	
	139.18076	139.18857	
	139.18086	139.18975	
	139.18096	139.18978	
	139.18450.		139.18450D
	139.18451		139.18451D
	139.18452		139.18452D
	139.18453		139.18453D
	139.18458		139.18458D
	139.18470.		139.18470D
	139.18473		139.18473D
	139.18475		
	139.18525		
	139.18555		139.18555D
	139.18595		
DC Units	139.18400.		
Belt Drive	139.18479	139.18887	
Units	139.18489	139.18897	139.18489D
	139.18585	139.18979	139.18585D
	139.18679	139.18987	
	139.18687		

	1997 - 2005	2005+
	Sec+ - 390M hz	Sec+ - 315M hz
Chain/Cable	139.53661	139.53648D
Drive	139.53662	
Units	139.53670	
	139.53671	
	139.53672	
	139.53673	
	139.53674	
	139.53675	
	139.53677	
	139.53910	139.53910D
	139.53959srt	
	139.53961	
	139.53962	
	139.53966	
	139.53974	
	139.53975	
	139.53976	
	139.53977srt	
	139.53978	
	139.53982	
	139.53985	139.53985D
	139.5398511	
	139.53989	
	139.53990	139.53990D
	139.5399011	
	139.53995	
		139.53997D
Screw Drive	139.53663	
Units	139.53927	
	139.53963	
	139.53965srt	
	139.53991	
	139.53992	139.53992D
	139.5399211	
		139.53930D
Screw Drive	139.53924	
Belt Drive	139.53664	
Units	139.53914	139.53914D
	139.53954	
	139.53964	
	139.53984srt	
DC Units		139.53918D
	139.53919	139.53919D