

# START HERE



DO-IT-YOURSELF

## SECURITY AND AUTOMATION PACKAGE ESSENTIAL STEPS

HERE ARE SOME KEY POINTS YOU'LL WANT TO KNOW.

### 1. TEST YOUR SYSTEM

Press Security ▶ Menu ▶ Toolbox ▶ Enter 4 digit master code ▶ System Test. Then trigger each sensor to provide feedback at the panel.

### 2. ACTIVATE YOUR SYSTEM

After installing your system your 24/7 monitoring will **not** be activated until you call **1-877-826-5443** or email [activations@linkinteractive.com](mailto:activations@linkinteractive.com).

You will receive an email providing you with the phone number for the monitoring center, your account number and password. You will also receive an attachment to the email which contains a Certificate of Monitoring which you may provide to your insurance company in order to receive any discounts offered.

Please note that if you do not install your system within 30 days from the ship date, we will automatically activate your system for you.

### 3. ADD LINK INTERACTIVE TO YOUR SAFE-SENDERS LIST

We will be communicating with you via email with information regarding your system. Please add the following email address to your safe-senders list:

[customerservice@linkinteractive.com](mailto:customerservice@linkinteractive.com)

### 4. REGISTER YOUR ALARM SYSTEM WITH LOCAL AGENCIES

You may be required to register your new alarm system with your local police department, sheriff's office or emergency agencies depending on your installation address. It is your responsibility to contact your local authorities to determine registration, permit or licensing requirements. Failure to comply with the permitting requirements of your local authorities may result in a fine. Any fines or fees assessed to Link Interactive for failing to comply with the permitting requirements will be charged in full to your customer account.

Please call with any questions: 877-826-5443 - M-F 7 a.m. to 8 p.m. and Saturday 8 a.m. to 4 p.m. - Mountain Time

### 5. REVIEWS AND REFERRALS

We love to read your reviews and want to know that you're completely satisfied with our products and services. Please review us on Yelp, Angie's List, Google+, TrustPilot or the BBB.

Much of our business is grown through our customer's referrals to friends and family. If someone you know orders a system from us and lets us know you referred them, we'll say 'thank you' by crediting both accounts with one free month of monitoring!

**STOP! DO NOT RETURN EQUIPMENT TO RETAILER. CONTACT LINK FOR ALL PRODUCT RETURNS/WARRANTY QUESTIONS.**



# 1-877-826-5443



# 1

## Start Here: Install Go!Control Alarm Panel

For installation instructions for all other components go to <https://www.linkinteractive.com/installation-guide/>

### STEP 1

Remove your equipment from the shipping box. Open the inner box that contains your alarm panel marked with the green sticker. Do not plug your panel into an electrical outlet at this time.

### STEP 2

#### DESK MOUNT OPTION

With a small Phillips screwdriver, remove the screw on top of the panel (fig 1). Insert a small straight screwdriver into the slots and give a gentle quarter turn, releasing the back plate (fig 2). Remove the AC barrel plug from panel, feed it through the desk mount, back plate and reconnect to panel and reattach back plate to panel (fig 3). Place the flat antenna inside the desk mount. Snap the desk mount to the back of the panel (fig 4).

#### WALL MOUNT OPTION

Make sure your desired location has a non-GFI wall outlet nearby. With a small Phillips screwdriver, remove the screw on top of the panel (fig 1). Insert a small straight screwdriver into the slots and give a gentle quarter turn, releasing the back plate (fig 2). Gently bring the antenna through the back plate opening towards the panel. Using care not to break the back plate, pop off the tabs in the wire channel guide on the back and press the power cord into it. Mount the back plate to the wall. Create a small hole in the wall directly behind the small oval opening. Feed the antenna back through the small oval opening and into the hole in the wall to allow the antenna to hang freely inside the wall behind the back plate. Mount the panel to the back plate by snapping it onto the back plate and replacing the screw.

### STEP 3

Choose a central location for your alarm panel that is not visible from outside your home. Plug the panel into an outlet that is not a GFI or controlled by a switch, then wait approximately 30 seconds while it powers up and receives its cellular connection

### STEP 4

Change your panel's default code from 1111 to a safer master code. At the panel follow this sequence:  
press Security ▶ press Menu ▶ press Toolbox ▶  
enter 1111 ▶ press User Management ▶ press Master User  
press Change Pin 1111 ▶ enter new code ▶ press OK ▶  
enter new code again to confirm and press OK ▶  
press Home button.

### STEP 5

For installation instructions for all other components go to <https://www.linkinteractive.com/installation-guide/>

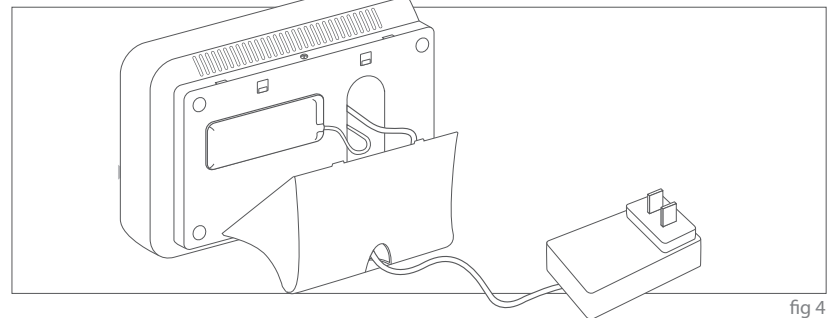
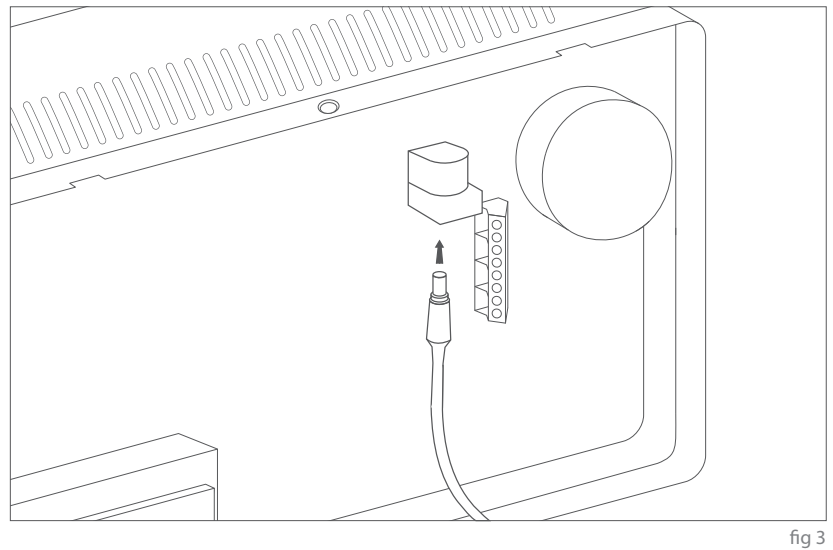
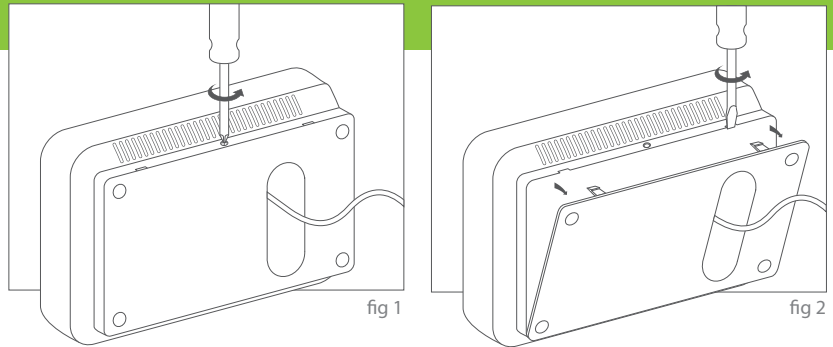

## Setting the Chime Feature

At the panel follow this sequence:

press Security ▶ press Menu ▶ press Toolbox ▶ press Chimes ▶  
choose which item to set Chime for ▶ choose Chime option ▶  
press OK ▶ press Home Button

### Note

You can enter up to 31 other user codes with optional operational and expiration dates.

